

# SACRAMENT

TATTOOS/HACKBRIDGE



[WWW.SACRAMENTTATTOOS.COM](http://WWW.SACRAMENTTATTOOS.COM) @SACRAMENTTATTOOS 02087732166



**SACRAMENT** IS A HOMEGROWN TATTOO STUDIO CO-OWNED BY LOCAL ARTISTS LUIS JONES AND STEVE KERR.

APPRENTICES:  
**KIERAN ROBERTS** @KIZ.TATTOOS  
**ELLIE FAIRLAMB** @ELLESTATTOOS

WORKING TOGETHER THE LAST HALF DECADE HAS ALLOWED OUR SHARED VALUES AND WORK ETHIC TO BE AT THE FOREFRONT OF ALL THAT WE DO. WE HAVE BOTH ENJOYED WATCHING THE FRUITS OF OUR LABOUR GROW BY TURNING UP EVERYDAY, DEALING IN GOOD FAITH AND PUTTING OUR BEST FOOT FORWARD. IT'S BEEN A REAL PRIVILEGE SERVING HACKBRIDGE AND THE SURROUNDING AREAS. WE ALSO RESIDENT A LARGE COLLECTIVE OF TALENTED AND HARD WORKING ARTISTS WHO COVER A WIDE RANGE OF STYLES. OUR CURRENT ROSTER OF ARTISTS ARE:

**LUIS JONES** @LUISJTATTOOS  
FREEHAND / JAPANESE / COMPLEX COVER UPS

**STEVE KERR** @STEVE\_KERR\_TATTOOS  
ILLUSTRATIVE / NEO TRADITIONAL / GEOMETRIC

**ROSIE MALONE** @ROSIEMALONETATTOOS  
ORNAMENTAL / BLACKWORK / FINELINE

**AMBER PEARCE** @AMBERLEENA\_TATTOOS  
HIGH CONTRAST REALISM / ANIMAL PORTRAITS / MICRO REALISM

**BRAD COMFORT** @COMFORTTATTOOS  
BRIGHT AND BOLD / FINE AND TEXTURED / TRADITIONAL

**GEORGE ROBERTS** @GTATTOOS666  
COLOUR REALISM / HORROR / PORTRAITS

**HERMIONE FINCH** @HERMIONETATTOOS  
BLACKWORK TRADITIONAL/ BOLD ORNAMENTAL / CLEAN COLOUR PACKING

**BECCA BYRNE** @EBONY\_INKZ  
CYBERSIGILISM / GOTHIC / STIPPLE

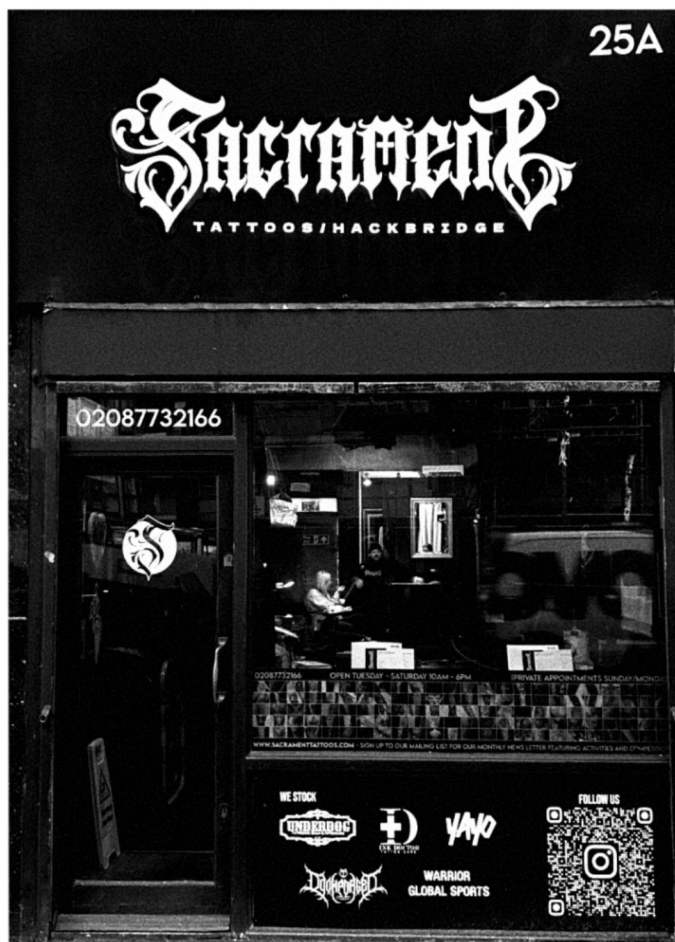

THE STUDIO IS SITUATED AT 25A LONDON ROAD, SM6 7HW (IN BETWEEN HOWARDS HAIR SALON AND HACKBRIDGE NAILS & BEAUTY).



---

CONTACT US:  
02087732166  
@SACRAMENTTATTOOS  
SACRAMENTTATTOOS@GMAIL.COM



# FEBRUARY NEWSLETTER

---

JANUARY HAS BEEN AND GONE AND CHRISTMAS FEELS LIKE A DISTANT MEMORY. THE COLDER NIGHTS ARE SLOWLY GETTING SHORTER AS THE DAYS ARE TRYING TO GET LONGER. IF YOU LOOK IN THE RIGHT PLACES YOU CAN SEE THE SNOWDROPS AND CROCUS FLOURISH THE GROUND WITH WHITE, PURPLE AND YELLOW. AS EACH DAY PASSES WE TAKE A STEP CLOSER TO SPRING. THE SEASON OF NEW BEGINNINGS.

THIS MONTH WE TEACH YOU HOW TO DRAW FLOWERS. WE HAVE THREE FULLY ANNOTATED HOW TO DRAWS FROM:

## **STEVE KERR**

NEO TRADITIONAL ROSE

*PAGE 4*

## **LUIS JONES**

JAPANESE CHRYSANTHEMUM

*PAGE 9*

## **KIERAN ROBERTS**

TRADITIONAL ROSE

*PAGE 14*

WE ALSO HAVE THREE BONUS WORKSHEETS  
FROM:

## **BECCA BYRNE**

NEO TRADITIONAL ROSE

*PAGE 20*

## **HERMIONE FINCH**

BLACKWORK PEONY

*PAGE 21*

## **ROSIE MALONE**

PEONY

*PAGE 22*

**COLOURING SHEETS** *PAGES 23 & 24*



WITH NATIONAL CAREERS WEEK FAST APPROACHING YOU MIGHT FIND US POPPING UP AT A CAREERS EVENT AT YOUR LOCAL HIGH SCHOOLS AND COLLEGES.

WE'VE HAD THE PLEASURE OF TALKING TO STUDENTS ABOUT SELF EMPLOYMENT AND DISCUSSING WHAT A CAREER WORKING FOR YOURSELF COULD LOOK LIKE.

WE'VE ANSWERED MANY QUESTIONS ON:

- WHAT MAKES AN APPRENTICESHIP GOOD
- WHAT TO AVOID
- HOW TO STAY MOTIVATED

IT'S BEEN A GENUINE PRIVILEGE ENGAGING WITH SO MANY BRIGHT AND CREATIVE STUDENTS. IF YOU HAVE ANY CAREER LEADS AND WOULD LIKE US TO ATTEND YOUR EVENT PLEASE EMAIL US AT:

**SACRAMENTTATTOOS@GMAIL.COM**



# HOW TO DRAW A NEO TRADITIONAL ROSE WITH STEVE KERR.

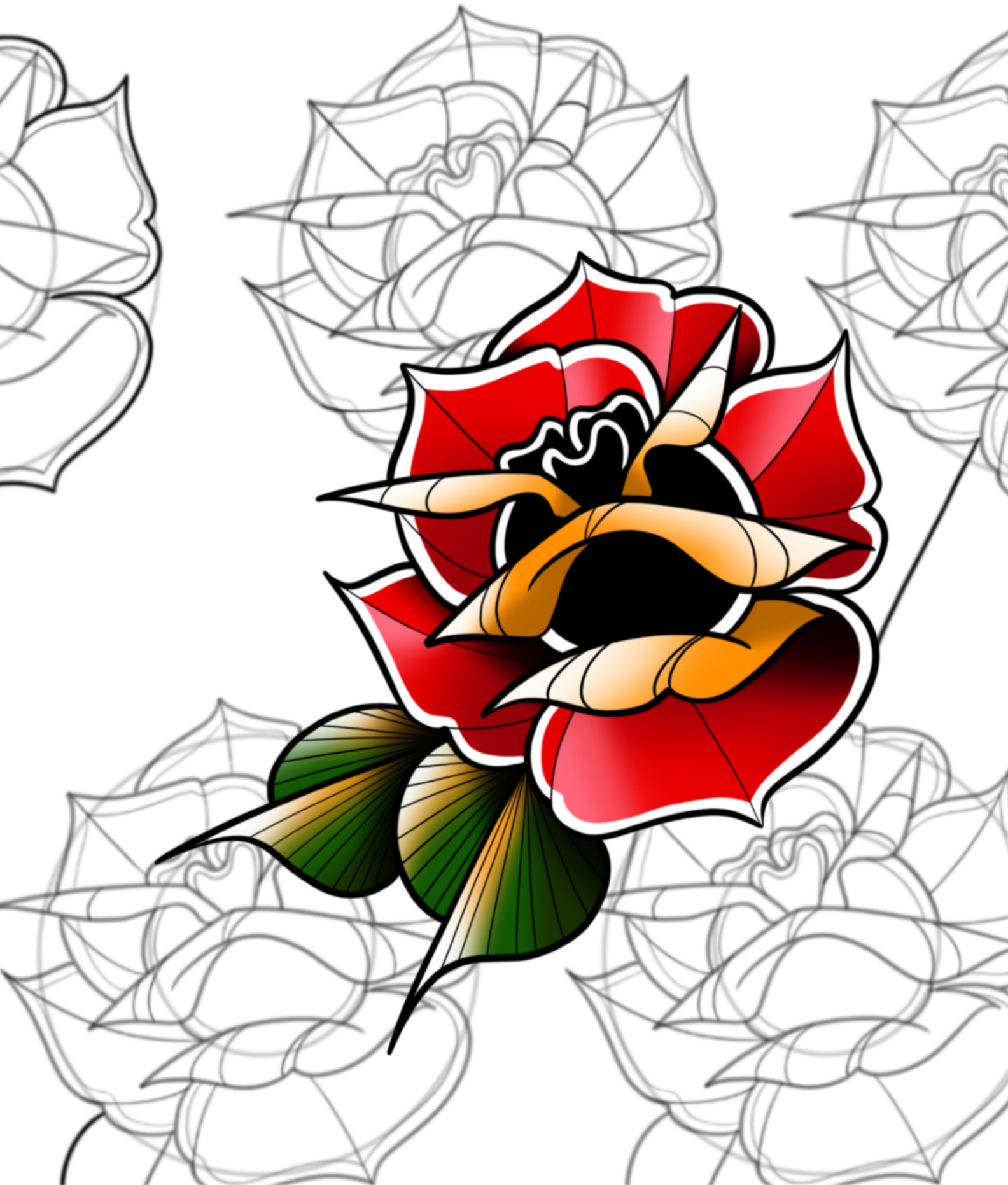



# NEO TRAD ROSE BY STEVE KERR



## STEP 1:

DRAW TWO CIRCLES, ONE INSIDE THE OTHER. BIT LIKE AN EGG. THESE WILL SERVE AS BOUNDARIES FOR YOUR INNER AND OUTER PETALS.

BREAK UP THE MIDDLE CIRCLE WITH THESE 4 LINE FROM BOTTOM TO TOP. THESE WILL BECOME PETAL FOLDS WHICH WILL SERVE AS A TRANSITION FROM THE INNER TO OUTER PETALS.



## STEP 2:

LET'S ADD THE UNDERSIDE TO OUR FOLDS. AS WE'RE LEANING INTO A NEO TRADITIONAL STYLE WE CAN MAKE THE POINTS A BIT SHARPER AND CURVES A BIT BOUNCIER.

I ALMOST TREAT THE FOLDS LIKE BROWS, MOUSTACHE/LIPS. IT HELPS ADD CHARACTER.



## STEP 3:

TO FINISH THE BOUNDARIES OF THE INNER PETALS WE NEED TO TRACE JUST OUTSIDE THE CENTRE CIRCLE TO CLOSE THE UNDERSIDE OF THE BUD. IT KEEPS IT CIRCULAR BUT ASYMMETRIC.

TO CLOSE THE TOP WE ADD THREE TINY PETALS IN THE SHAPE OF A WOBBLY M. MAKE SURE TO STAGGER THE LAYERS TO CREATE DEPTH.



## STEP 4:

TO FINISH THE INSIDE OF THE ROSE BUD WE NEED TO ADD A SKIN GAP THE WHOLE WAY AROUND. THIS WILL INSURE WE KEEP EVERYTHING SEPARATE AND READABLE.





# NEO TRAD ROSE BY STEVE KERR



**STEP 5:**  
STARTING FROM THE BOTTOM AND  
WORKING YOUR WAY UP. ADD 5  
PETALS WITH A SKIN GAP.

WITH THIS ROSE I'VE DECIDED THE  
RULE FOR THE PETALS ARE:



**STEP 6:**  
GIVE THE PETALS DIRECTION AND  
DEPTH BY ADDING FOLD LINES  
THROUGH THE PETALS. USE THE V  
SHAPES WE'VE CREATED AS  
STARTING POINT THEN SHAPE A LINE  
TOWARDS WHERE THEY WOULD MEET  
THE BUD.



**STEP 7:**  
I LIKE TO ADD AT LEAST A COUPLE  
LEAVES COMING FROM THE ROSE, AS  
IF YOU'RE LOOKING DOWN AT IT.  
START BY ADDING THE MIDDLE FOLD  
OF THE LEAF.



**STEP 8:**  
THE RULE FOR THE UNDERSIDE OF  
THE LEAF IS A SHARPER POINT-  
BOUNCE WHILST AIMING FOR THE  
BOTTOM OF THE LEAF FOLD.

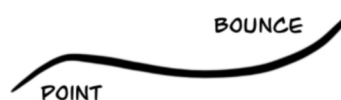



# NEO TRAD ROSE BY STEVE KERR



**STEP 9:**  
FOR THE FAR SIDE OF THE LEAF DO A  
SINGLE BOUNCE.



**STEP 10:**  
STARTING AT THE BOTTOM OF THE  
LEAF TOUCHING THE PETALS, IN  
ONE MOTION, ADD TEXTURE LINES  
THROUGH BOTH SIDES OF THE LEAF  
TO SHAPE IT.



**STEP 11:**  
ADD ANOTHER LEAF, FOLLOW STEPS  
7 - 10 IF YOU NEED ANY HELP.

# NEO TRAD ROSE BY STEVE KERR

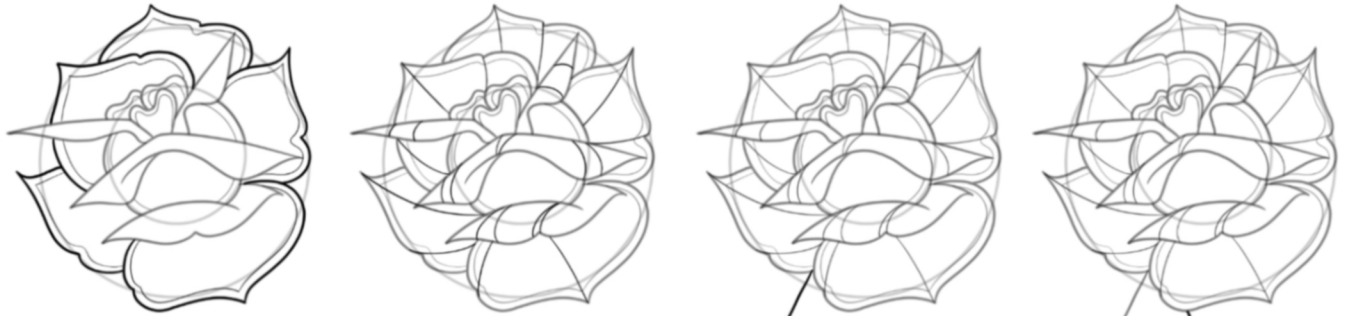
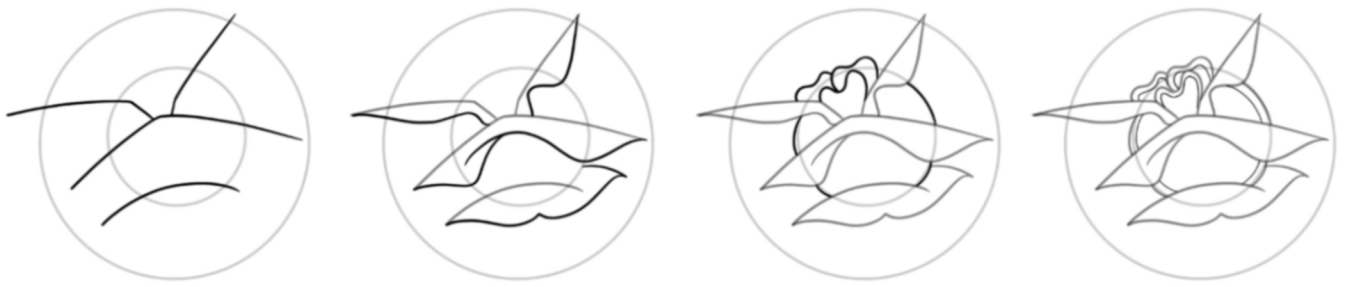



How to draw  
A Japanese  
*Chrysanthemum*

By Luis Jones

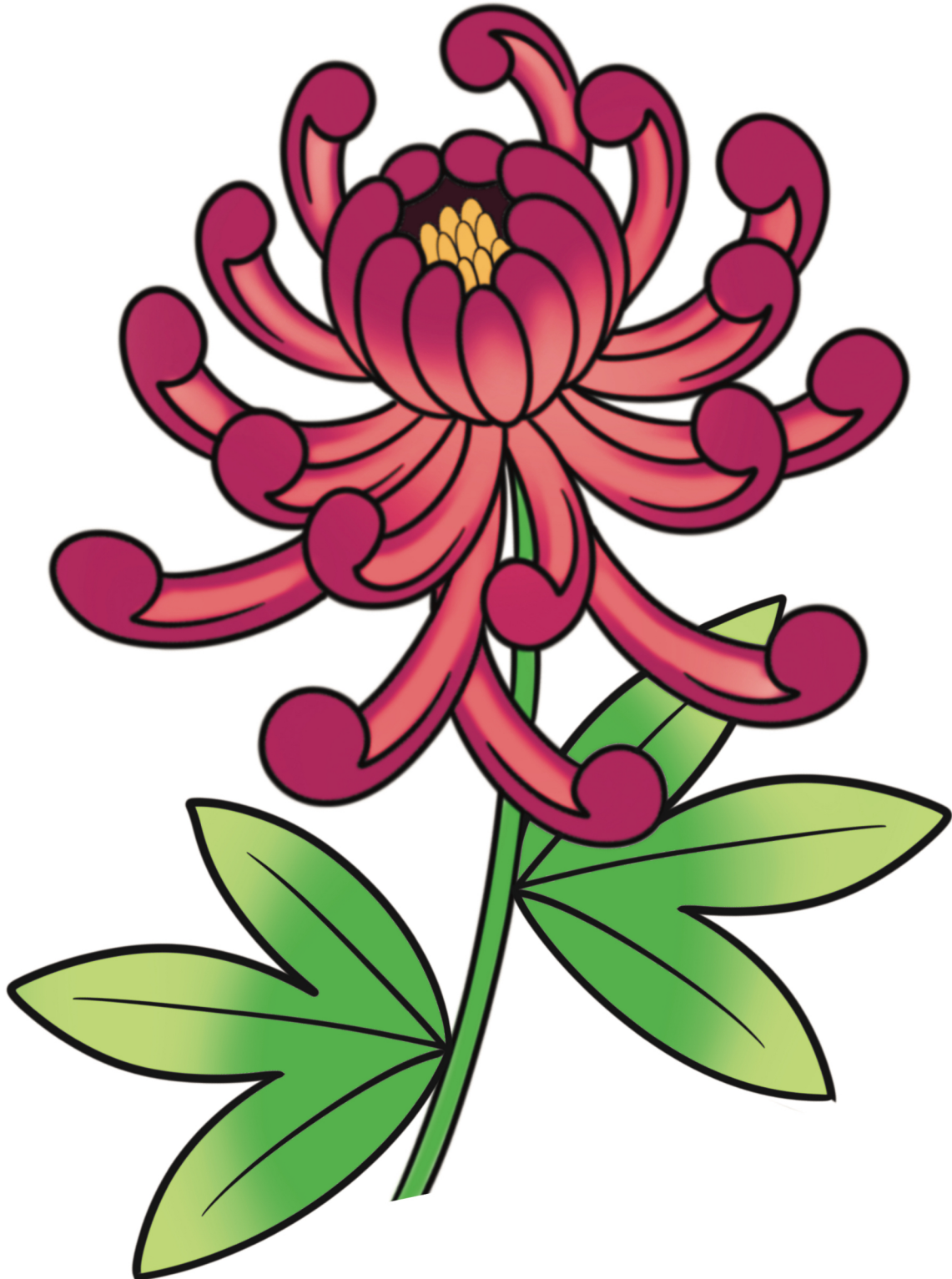

# How to draw *A Japanese Chrysanthemum*

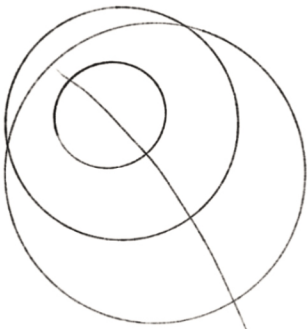

Step 1: draw 3 circle, one central, one around and then one larger slightly lower and then add a curved line through the centre to make the petal layers and stem.

Step 2: I like to start with the outer layers of petals incase I want any to overlap the other layers, for this I draw a curved line with a small circle at the end, use pencil as these will be erased later, each line starts from the bottom of the centre circle and out to the or passed the last circle.

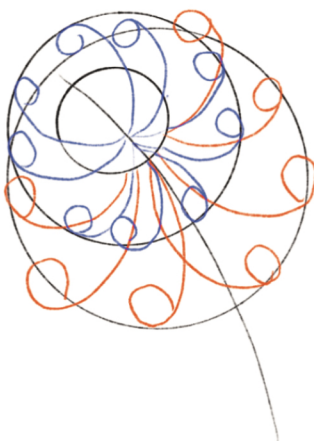
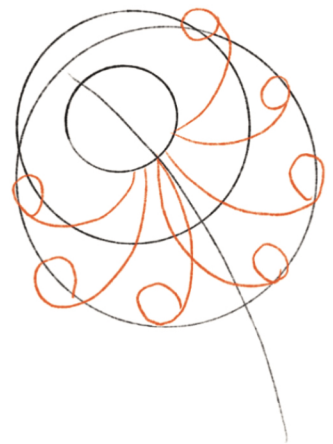

Step 3: Same shapes again but staying within the second circle now, this gives you the flow for your next layer of petals, you are able to place them where you like, you just want to avoid the ends of the petals over lapping each other for later.

Step 4: Next is the centrl bud, which you want to use the same shape for the petals as before but build them into a circle creating a enclosed shape for the petals to branch out from.

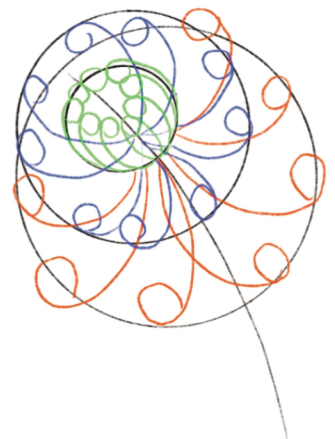



# How to draw *A Japanese Chrysanthemum*

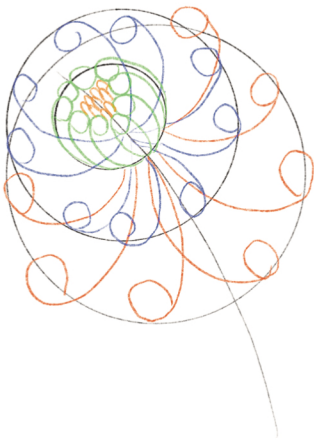

Step 5: This step is small, here you do little finger shapes in the centre of the bud which is the stemen of the flower

Step 6: Mark out the stem but following the initial line you made for it and adding a second line beside it to give the stem a bit of thickness and structure; wide enough that it looks like it could hold the weight of the flower head, if the flower is bigger, the stem will be bigger too.

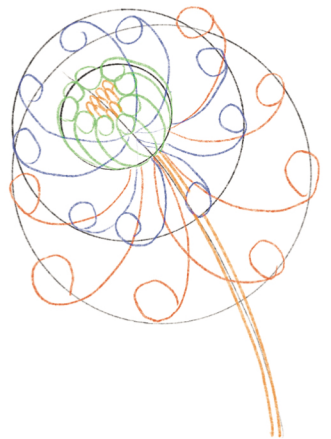

Step 7: Now the main structure is done I like to get rid of the circles from the start to see the full flow of the petals .

Step 8: Now it's time to line the flower starting with the centre start with an oval in the middle of the bud and then following the shapes from earlier going around the small circle me down the curved line, this is the outside of each petal in the bud, as they curve to the back they get slightly smaller until the back petals become circles only.

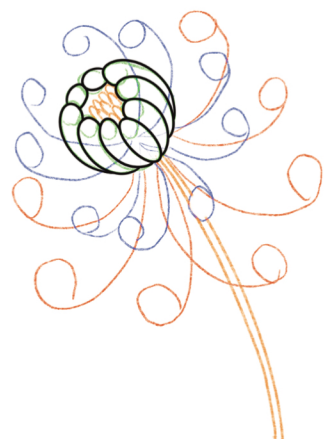

# How to draw A Japanese Chrysanthemum

Imagine the curve is here  
Do not draw this in.



Step 9: This is the tricky bit so I have included extra steps for this process... here you need to draw each petal from the outside line and into the circle but stop the circle short of connecting, then you want to do a small line to indicate the inside of the petal, and another line to show the other end of the inside.

Step 10: Once you have drawn the middle and second layer of petals, you can continue on to the last row, they will be a little bigger but still using the same shape as before.

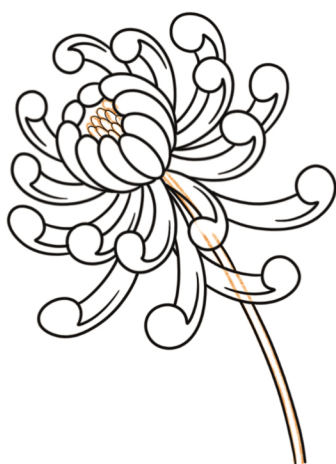
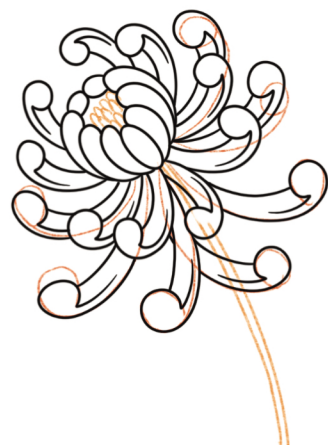

Step 11: Draw the centre stamen, the little finger shapes, and line the stem making sure the lines for it do not go through the petals.

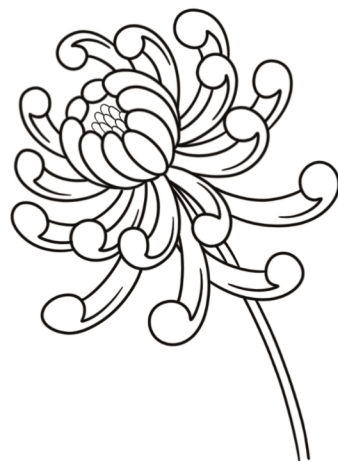

Step 12: You can now erase any pencil lines and you'll have a finished chrysanthemum ready to colour and/or add leaves to if you wish. I have included a fully coloured version at the start to show what it can look like, but you can do your own thing, that's half the fun.



# JAPANESE CHRYSANTHEMUM BY LUIS JONES

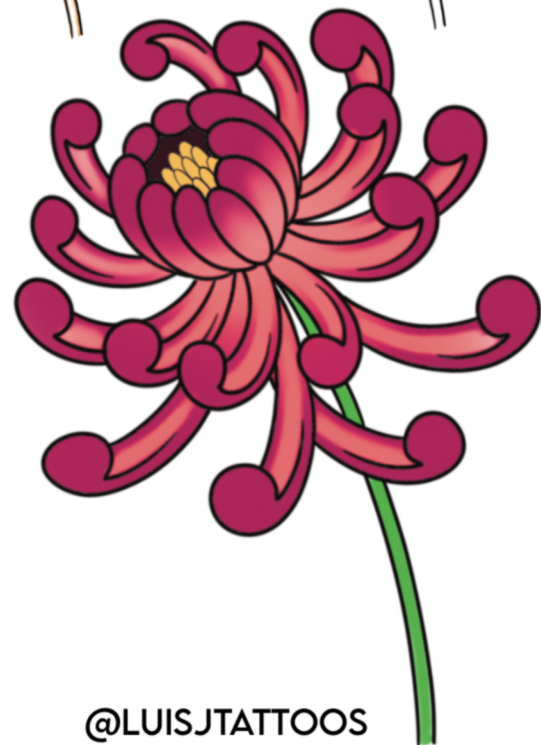
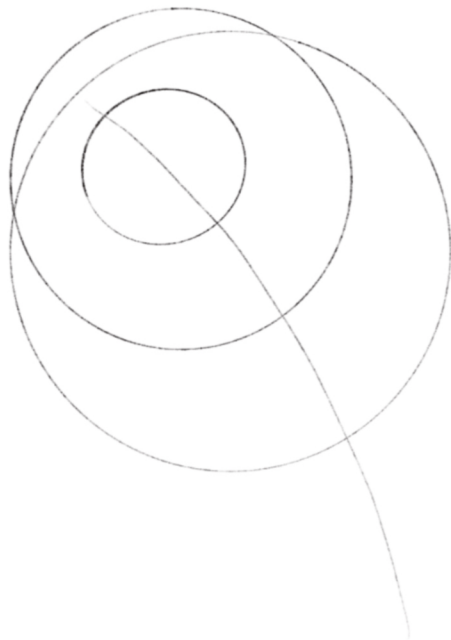
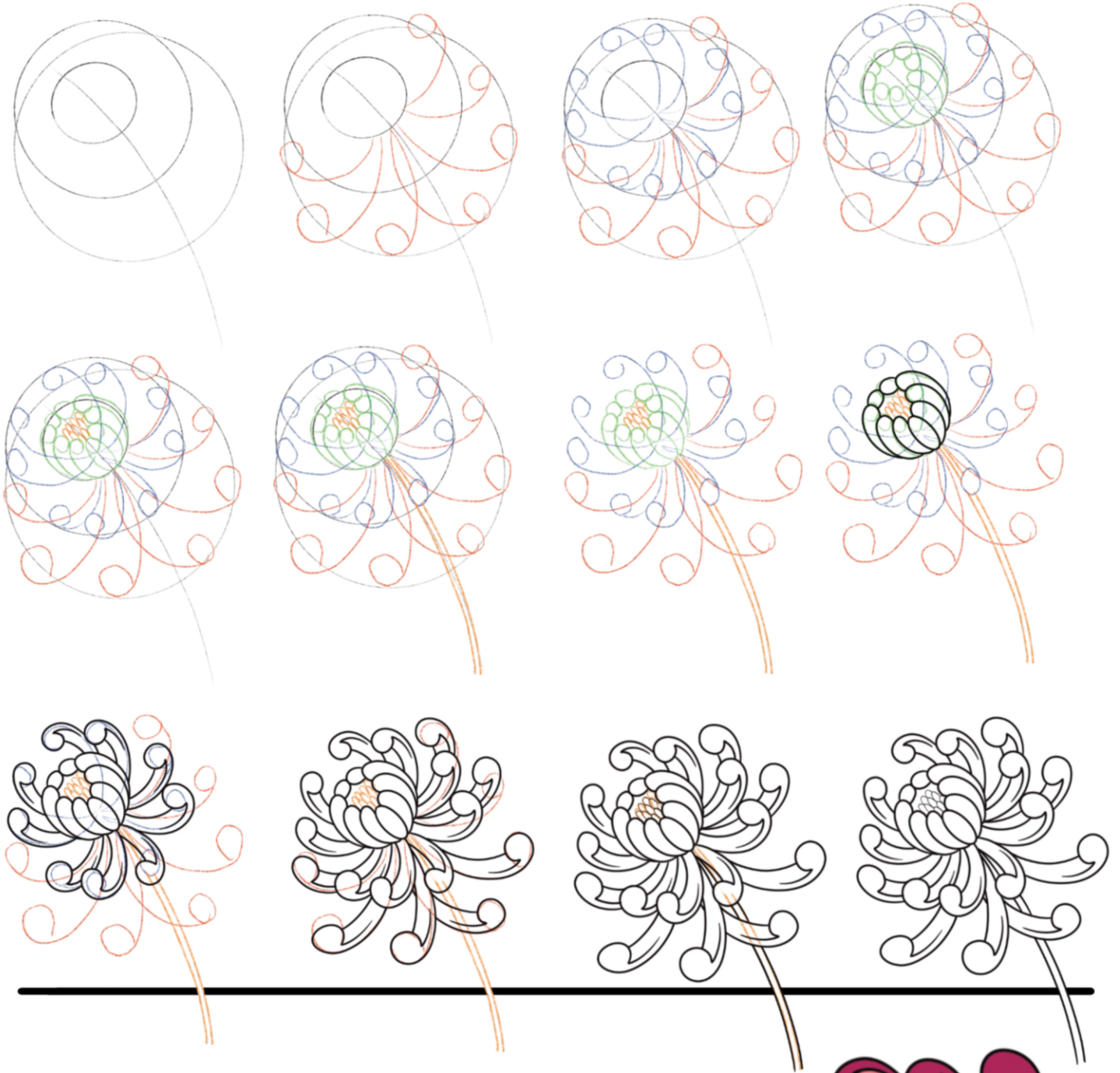

# HOW TO DRAW A TRADITIONAL ROSE



BY  
KIERAN ROBERTS



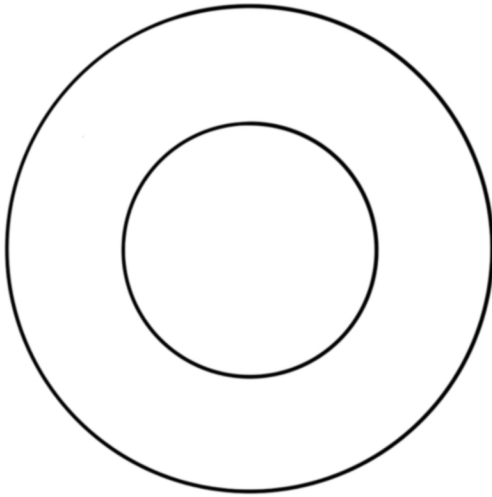

#### STEP 1.

DRAW A CIRCLE, AND THEN DRAW A SMALLER CIRCLE IN THE CENTRE OF IT

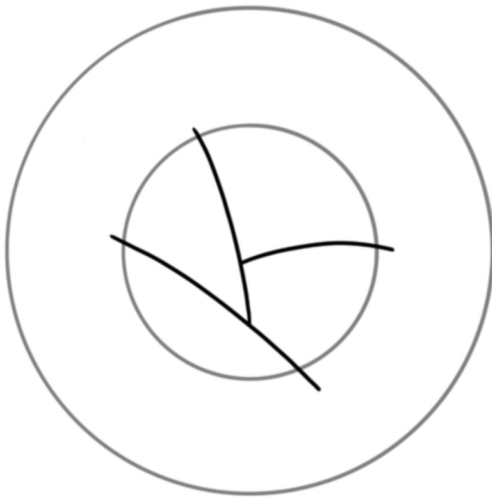

#### STEP 2.

DRAW A LINE SEGMENTING THE BOTTOM THIRD OF THE CIRCLE, AND THEN DRAW A “Y SHAPE” ABOVE IT

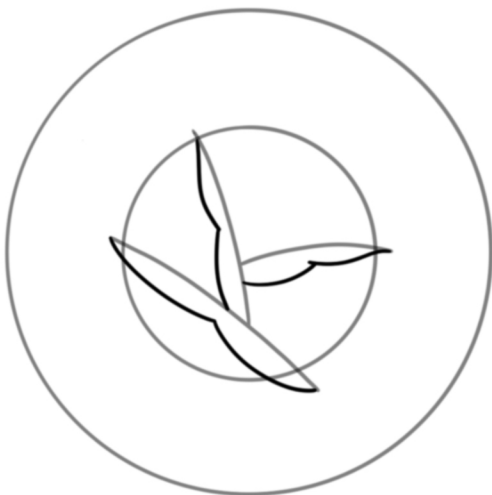

#### STEP 3.

ON EACH OF THESE LINES DRAW TWO ARCS, MEETING AT THE MIDDLE OF THE LINE TO CREATE THE PETAL FOLDS.

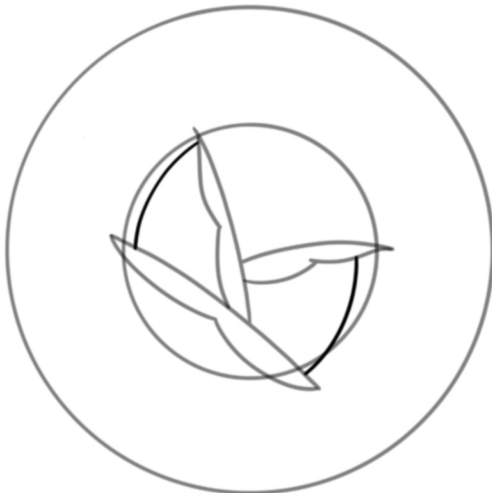

#### STEP 4.

CONNECT THE FOLDS USING TWO ARCS JUST INSIDE THE ORIGINAL CIRCLE, TO SHAPE THE ROSE

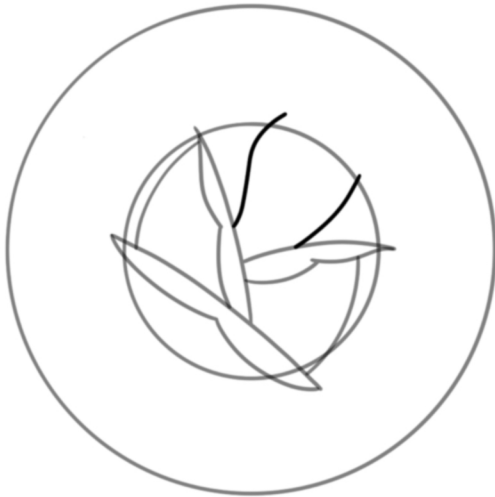

STEP 5.  
ADD TWO LINES IN THE MIDDLE OF  
THE BUD



STEP 6.  
IN BETWEEN THESE TWO LINES  
DRAW A WIDE "C SHAPE" AND  
CONNECT THEM TO EACH FOLD TO  
MAKE THE CENTRE SHAPE



STEP 7.  
DRAW IN ADDITIONAL FOLDS TO  
SHAPE THE TOP OF THE ROSE BUD



STEP 8.  
ADD IN 3 MORE ARCS WITHIN THE  
ORIGINAL CIRCLE TO FINISH UP THE  
CENTRE OF THE ROSE





STEP 12.  
FROM THOSE POINTS, ADD A LEAF  
SHAPE WITH THE POINT IN LINE  
WITH THE END OF THE TRIANGLE.  
ADD IN SEMICIRCLES CONNECTING  
EACH POINT UP TO MAKE VEINS.

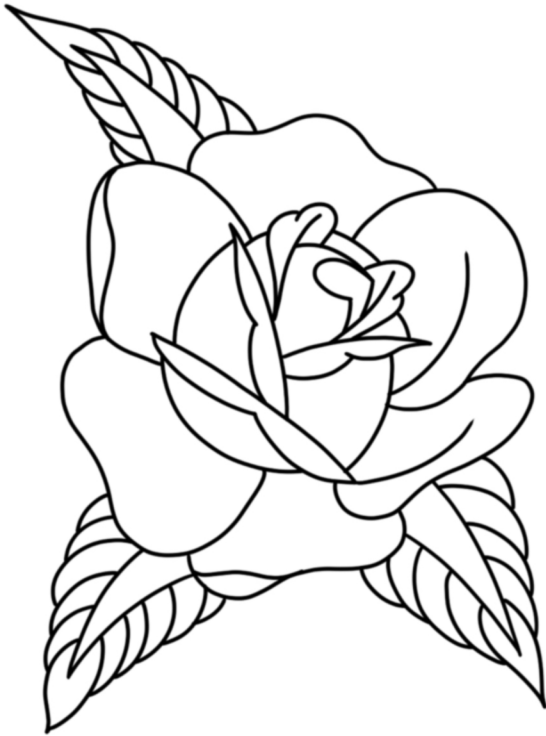

STEP 13.  
ERASE ANY UNNEEDED LINES AND  
GO OVER THE DESIGN WITH A PEN,  
RESHAPING ANY PARTS THAT YOU  
WANT TO BE THICKER OR THINNER

SHADING AND COLOUR  
ADD BLACK INTO ANYWHERE  
WHERE A LEAF OR PETAL  
WOULD BE ON TOP OF OR  
OVERLAPPING ANOTHER.  
THEN ADD IN COLOUR,  
ENSURING A CLEAR GAP  
TOWARDS ANY OUTSIDE  
EDGES

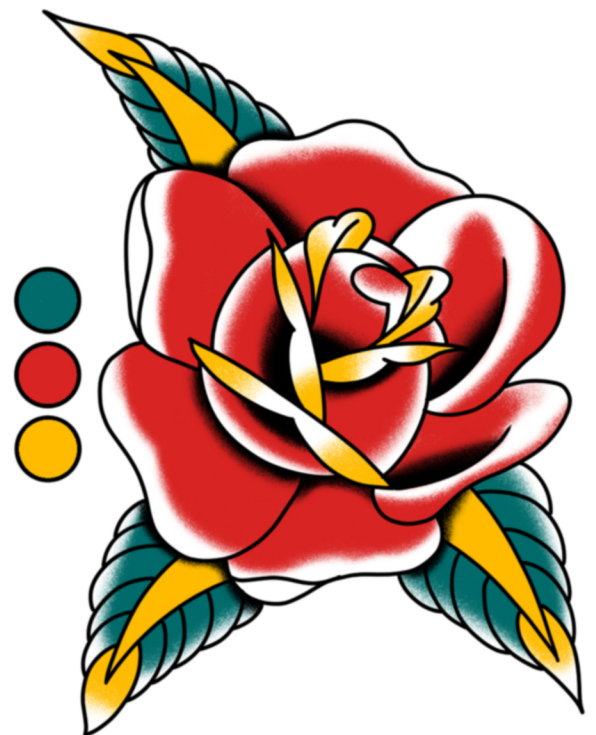

# TRADITIONAL ROSE BY KIERAN ROBERTS

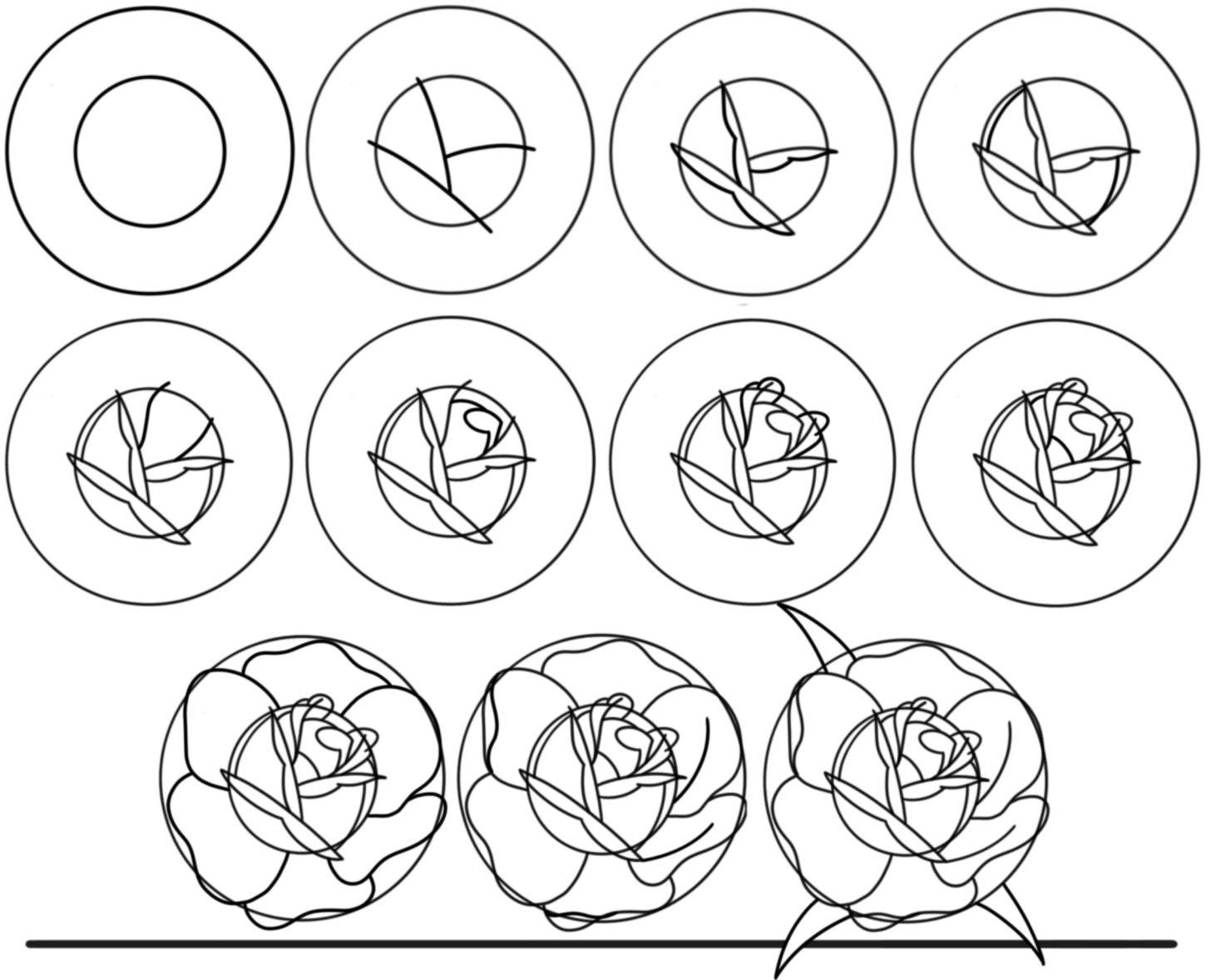



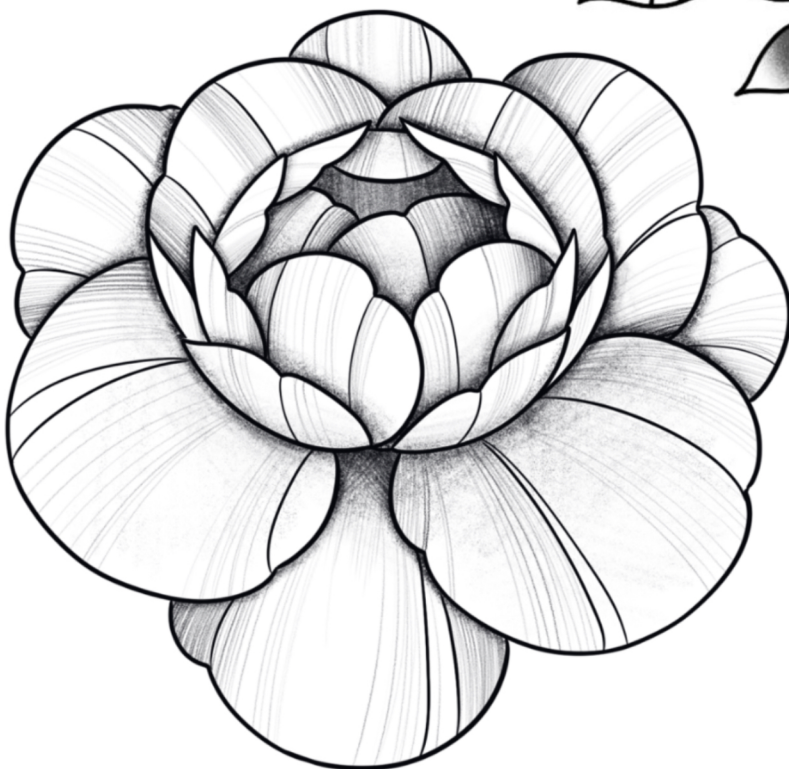

EXTRA WORK SHEETS

# NEO TRAD ROSE BY BECCA BYRNE

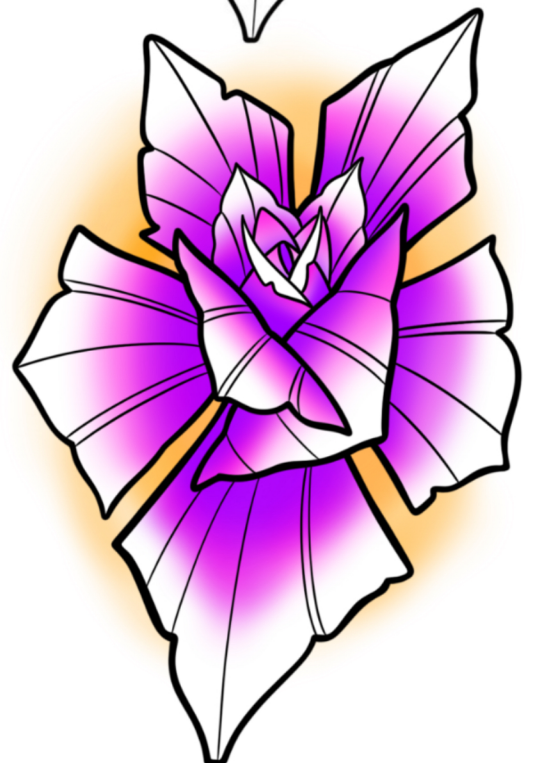
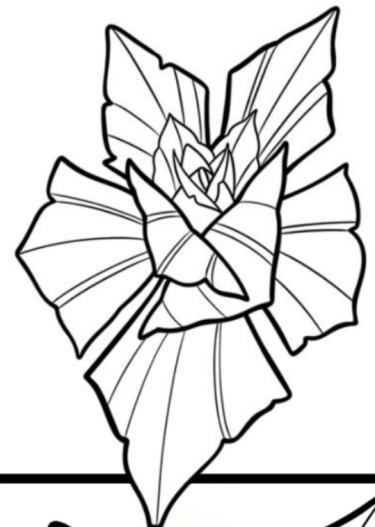
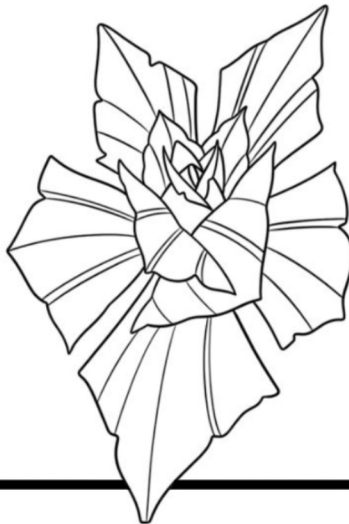
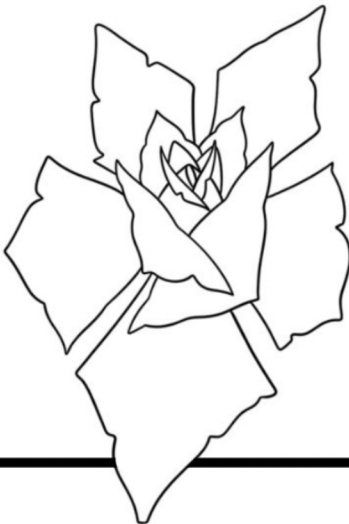
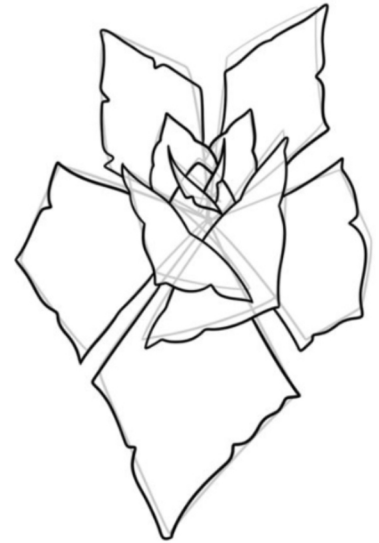
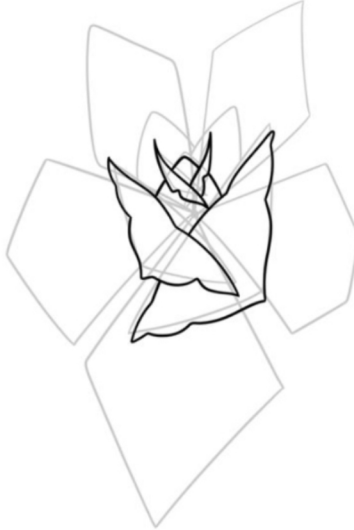
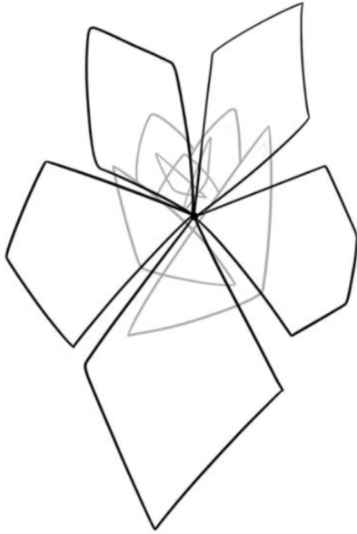



# BLACKWORK PEONY BY HERMIONE FINCH

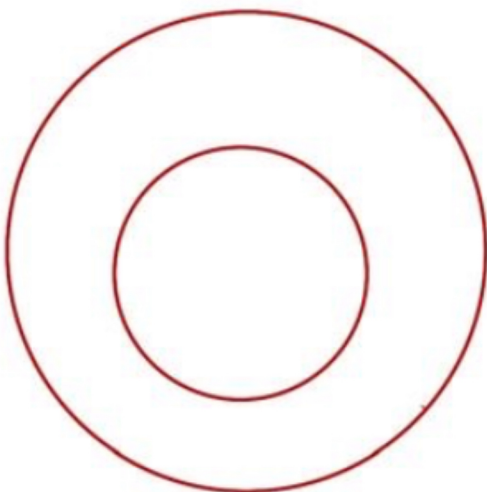
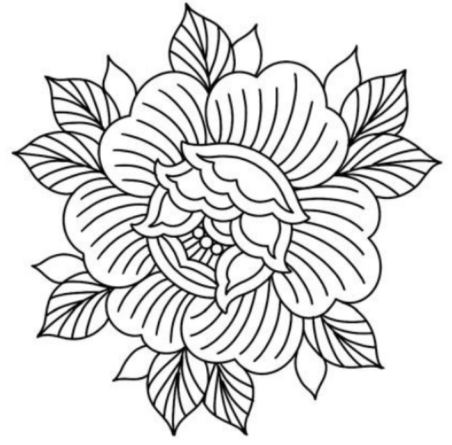
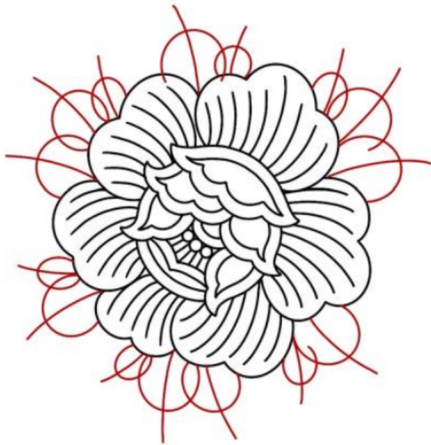
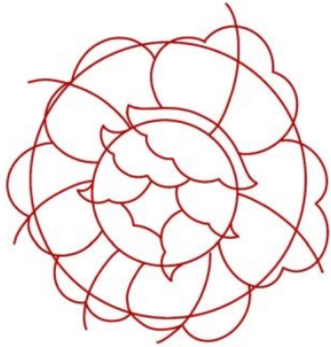
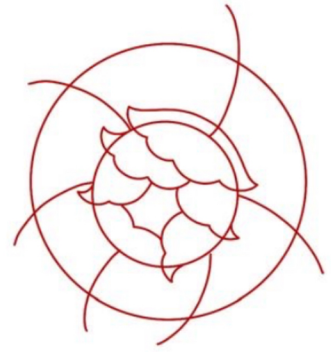
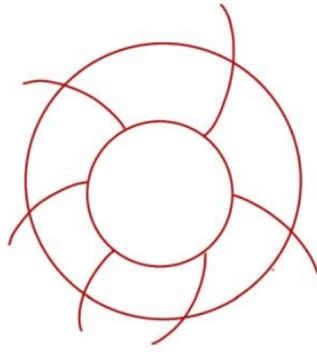
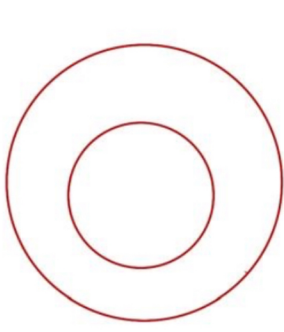

# PEONY BY ROSIE MALONE

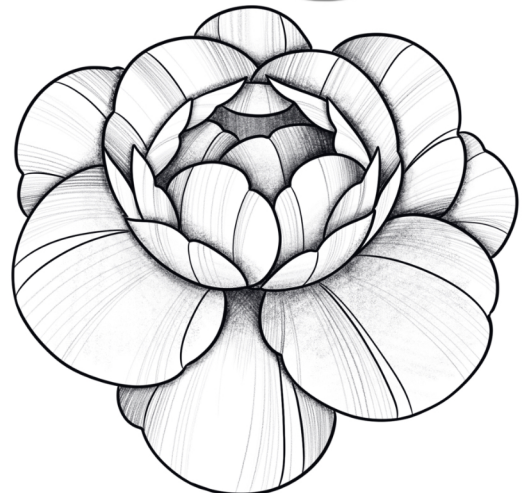
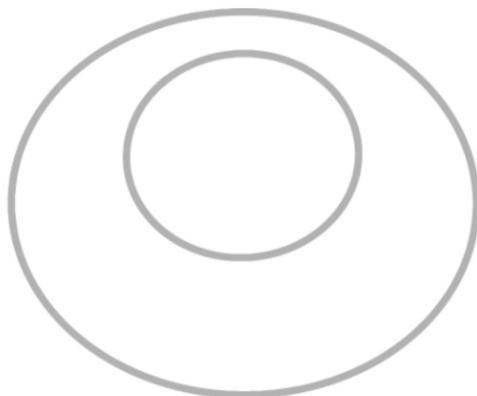
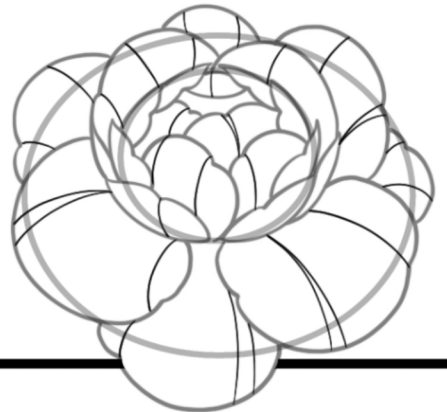
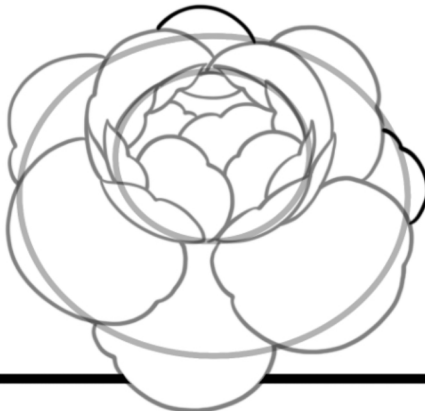
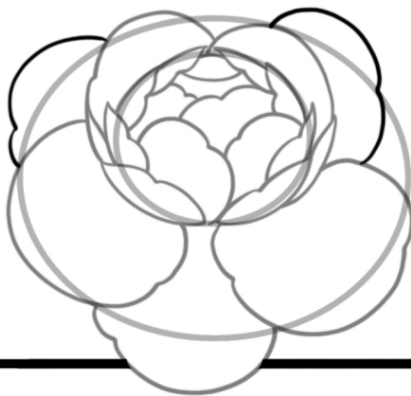
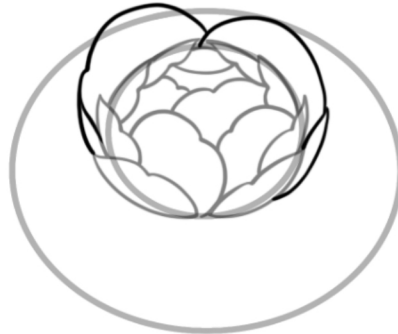
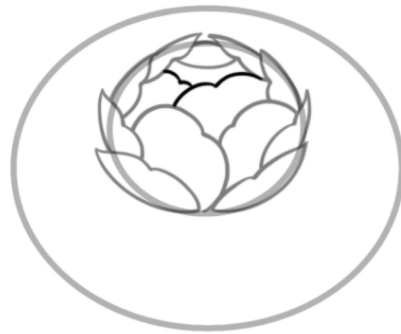
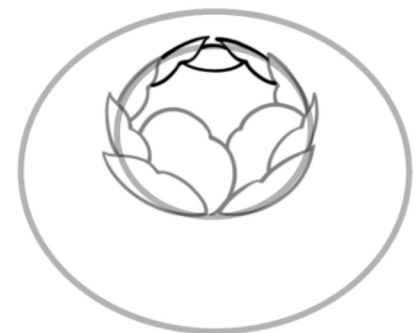
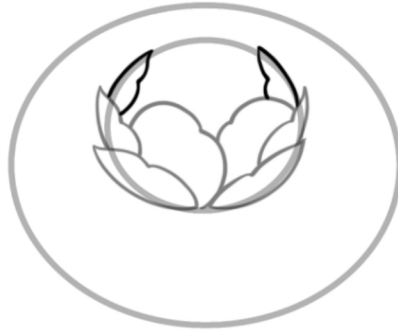
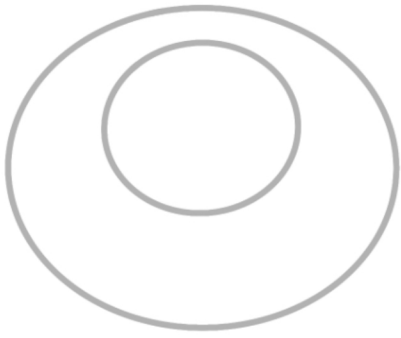







MYSELF AND LUIS HOPE YOU'VE ENJOYED THIS MONTH'S NEWSLETTER. WE LOOK FORWARD TO TOUCHING BASE WITH YOU IN MARCH.

MAKE SURE TO FOLLOW US ON INSTAGRAM AND TAG US IN YOUR (OR YOUR CHILDREN'S) DRAWINGS/ COLOURING IN FOR A CHANCE TO WIN PRIZES.

TO ENTER FOLLOW THESE ACCOUNTS:

**@SACRAMENTTATTOOS**  
**@STEVE\_KERR\_TATTOOS**  
**@LUISJTATTOOS**

THEN MAKE SURE TO TAG **@SACRAMENTTATTOOS** IN YOUR POST BY MARCH 1ST.

THIS MONTH YOU CAN WIN:

- AN A4 LIGHT PAD
- A SIGNATURE SACRAMENT HOODIE
- A SACRAMENT 5 PANEL CAP

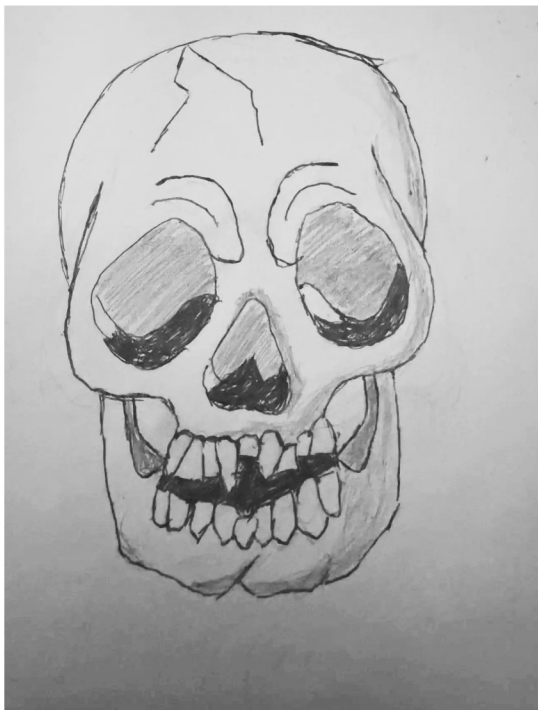

WELL DONE TO LAST MONTHS WINNER JAY



---

CONTACT US:  
02087732166  
**@SACRAMENTTATTOOS**  
**SACRAMENTTATTOOS@GMAIL.COM**





**NEW IN**  
**[WWW.SACRAMENTTATTOOS.COM](http://WWW.SACRAMENTTATTOOS.COM)**

